

Maßstab 1:100

— = 1m

— = 2m

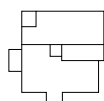
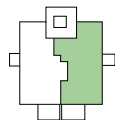
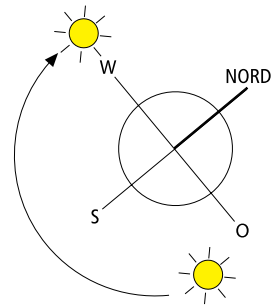

Haus 1
3-Zimmer-Wohnung
Nr. 4, 1. OG
Nr. 6, 2. OG

Wohnen/Essen	21,67 m ²
Küche	4,99 m ²
Schlafen	15,32 m ²
Bad	4,58 m ²

Zimmer	10,69 m ²
WC	1,59 m ²
Diele	9,24 m ²
Abstellraum	0,91 m ²
Balkon 1 (4 m ² /2)	2,00 m ²
Balkon 2 (8 m ² /2)	4,00 m ²

Gesamtwohnfläche 74,99 m²